



14/6 Isabel Street Ryde, NSW



Sold by Elisma Iesu 0422 462 010

- Two bedrooms, main with built-in and ceiling fan
- Refreshed kitchen
- Open plan living dining with ceiling fan
- Parquetry floors throughout
- Carspace at rear of block
- Share laundry with own power supply
- Walk to buses & Top Ryde Shopping Centre

SIZE:
54sqm internal approx.
67sqm total approx.

RATES:

Krystal Marshall

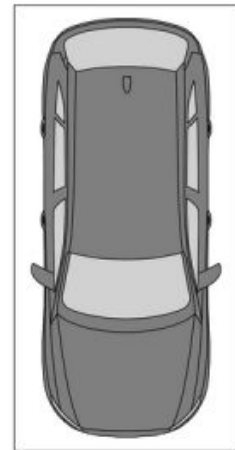
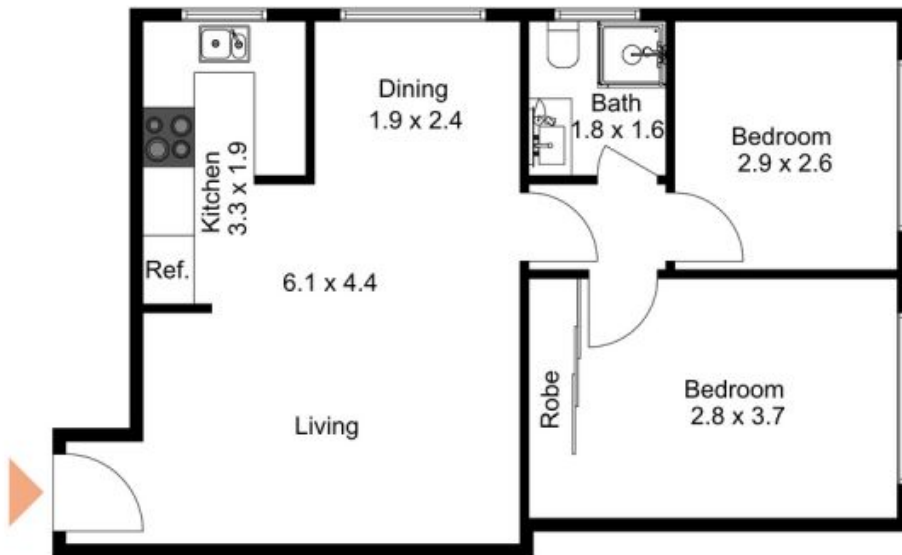

Car Space
(Not In Position)

14/6 Isabel St, Ryde



The floor plan is not to scale; measurements are indicative and in metres. Exterior elements are not in position. Plans should not be relied on. Interested parties should make and rely on their own enquiries.

Produced by **DIAKRIT**