



4/257 Blaxland Road RYDE, NSW



Perfect Presentation

We see a lot of renovations in our line of work, and this is one of the better ones. The kitchen is superb, with large work areas and plenty of storage. And with its North-east aspect and at the rear of the block, it's naturally light and beautifully quiet.

The best definition of a quality property.

- ? Air conditioning
- ? Renovated bathroom
- ? Renovated kitchen with lots of cupboards and bench space
- ? Dishwasher and ceramic cooktop
- ? Own laundry with a clothesline
- ? Built-in robes in both bedrooms
- ? Northeast-facing balcony
- ? Gleaming laminate timber floors
- ? Mid-floor position

Council Rates: \$1,296.00/year (approx)

Water Rates: \$640.00/year (approx)

Strata Rates: \$985.75 p/q

Stephen Jackson

0417211330

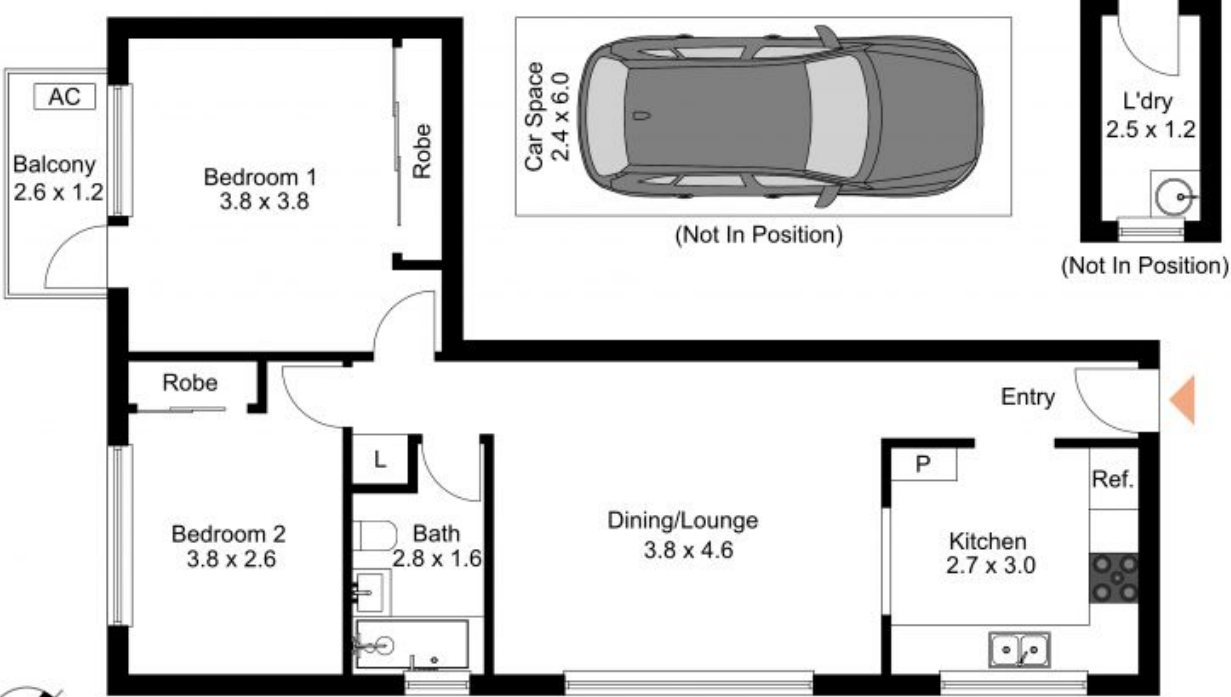

257 Blaxland Rd, Ryde

The floor plan is not to scale, measurements are indicative and in metres. Exterior elements are not in position. Plans should not be relied on. Interested parties should make and rely on their own enquiries.

Produced by **DIAKRIT**